

High speed in the smallest of spaces

RF-P gears were developed for fast applications in small spaces. They are immune to high shock loads, are low-maintenance, and designed for high speeds. That makes them the ideal candidate for pick & place, handling or positioning applications.

SPECIFICATIONS

Model RF-	19P	32P
Standard ratio	31	32,2 / 56
Rated torque (Nm)	190	320
Allowable acc./dec. torque (Nm)	570	960
Emergency stop torque (Nm)	570	960
Max. output speed (rpm)	200	92
Hysteresis loss (arcmin)	<2,0	<2,0
Torsional rigidity (Nm/arcmin)	66	149
Lifetime L_{10} (h)	20.000	20.000
Allowable moment (Nm)	650	1.960
Momentary max. allowable moment (Nm)	1.300	3.920

DIMENSIONS

Model RF-	19P	32P
Weight (kg)	5,6	9,5
A (mm)	71	78
B (∅mm)	148	183
C h7 (∅mm)	110	140
D (∅mm)	127	160

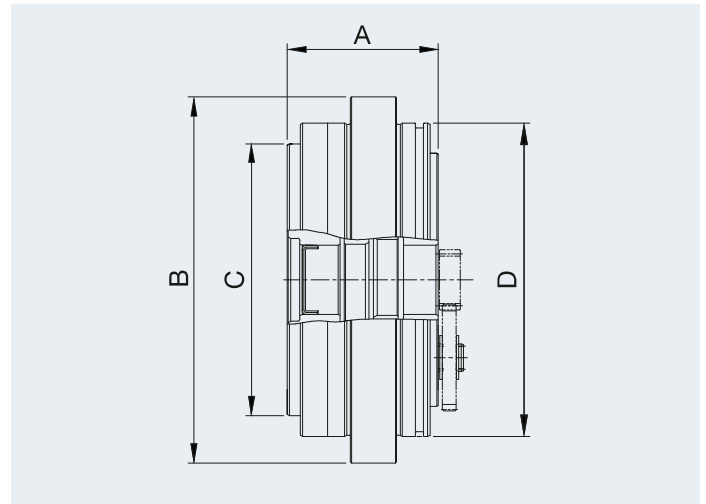

AREAS OF USE

- Robotics (particularly delta and scara robots)
- Automated Guide Vehicle (AGV)
- Pick & place applications
- Handling and positioning systems

ADVANTAGES

- High output speeds of up to 200 rpm
- Fast cycle times
- High precision (hysteresis loss <2 arc min.)
- Long service life 20.000 h



RF-P
Solid shaft
T: 190–320 Nm
i: 31–56
n: up to 200 rpm

