

## Models SR-W, SR-WM, SR-V and SR-VM

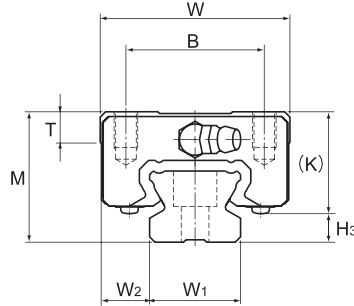

| Model No.                  | Outer dimensions |       |              | LM block dimensions |     |        |                |      |      |      |      |         |      | Grease nipple | H <sub>3</sub> |
|----------------------------|------------------|-------|--------------|---------------------|-----|--------|----------------|------|------|------|------|---------|------|---------------|----------------|
|                            | Height           | Width | Length       | B                   | C   | S×l    | L <sub>1</sub> | T    | K    | N    | E    |         |      |               |                |
|                            | M                | W     | L            |                     |     |        |                |      |      |      |      |         |      |               |                |
| SR 15W/WM<br>SR 15V/VM     | 24               | 34    | 57<br>40.4   | 26                  | 26  | M4×7   | 39.5<br>22.9   | 5.7  | 19.5 | 6    | 5.5  | PB1021B | 4.5  |               |                |
| SR 20W/WM<br>SR 20V/VM     | 28               | 42    | 66.2<br>47.3 | 32                  | 32  | M5×8   | 46.7<br>27.8   | 7.2  | 22   | 6    | 12   | B-M6F   | 6    |               |                |
| SR 25WY/WMY<br>SR 25VY/VMY | 33               | 48    | 83<br>59.2   | 35                  | 35  | M6×9   | 59<br>35.2     | 7.7  | 26   | 7    | 12   | B-M6F   | 7    |               |                |
| SR 30W/WM<br>SR 30V/VM     | 42               | 60    | 96.8<br>67.9 | 40                  | 40  | M8×12  | 69.3<br>40.4   | 8.5  | 32.5 | 8    | 12   | B-M6F   | 9.5  |               |                |
| SR 35W/WM<br>SR 35V/VM     | 48               | 70    | 111<br>77.6  | 50                  | 50  | M8×12  | 79<br>45.7     | 12.5 | 36.5 | 8.5  | 12   | B-M6F   | 11.5 |               |                |
| SR 45W                     | 60               | 86    | 126          | 60                  | 60  | M10×15 | 90.5           | 15   | 47.5 | 11.5 | 16   | B-PT1/8 | 12.5 |               |                |
| SR 55W                     | 68               | 100   | 156          | 75                  | 75  | M12×20 | 117            | 16.7 | 54.5 | 12   | 16   | B-PT1/8 | 13.5 |               |                |
| SR 70T                     | 85               | 126   | 194.6        | 90                  | 90  | M16×25 | 147.6          | 24.5 | 70   | 12   | 16   | B-PT1/8 | 15   |               |                |
| SR 85T                     | 110              | 156   | 180          | 100                 | 80  | M18×30 | 130            | 25.5 | 91.5 | 27   | 12   | A-PT1/8 | 18.5 |               |                |
| SR 100T                    | 120              | 178   | 200          | 120                 | 100 | M20×35 | 150            | 29.5 | 101  | 32   | 12   | A-PT1/8 | 19   |               |                |
| SR 120T                    | 110              | 205   | 235          | 160                 | 120 | M20×35 | 180            | 24   | 95   | 14   | 13.5 | B-PT1/4 | 15   |               |                |
| SR 150T                    | 135              | 250   | 280          | 200                 | 160 | M20×35 | 215            | 24   | 113  | 17   | 13.5 | B-PT1/4 | 22   |               |                |

### Model number coding

**SR25 W 2 UU C0 M +1240L Y P T M -II**

| Model number | Type of LM block                       | Contamination protection accessory symbol (*1)  | Stainless steel LM block | LM rail length (in mm) | Applied to only 25 | Stainless steel LM rail  | Symbol for No. of rails used on the same plane (*4) |
|--------------|--|---|--------------------------|------------------------|--------------------|--|---|
| SR           | 25                                     | W   | 2                        | UU                     | C0                 | M  | +1240L Y P T M -II                                  |
|              | No. of LM blocks used on the same rail | Radial clearance symbol (*2)<br>Normal (No symbol)<br>Light preload (C1)<br>Medium preload (C0) |                          |                        |                    | Symbol for LM rail jointed use<br>Accuracy symbol (*3)<br>Normal grade (No Symbol)/High accuracy grade (H)<br>Precision grade (P)/Super precision grade (SP)<br>Ultra precision grade (UP) |   |

(\*1) See contamination protection accessory on A-368. (\*2) See A-114. (\*3) See A-119. (\*4) See A-59.

Note) This model number indicates that a single-rail unit constitutes one set. (i.e., required number of sets when 2 rails are used in parallel is 2 at a minimum.)

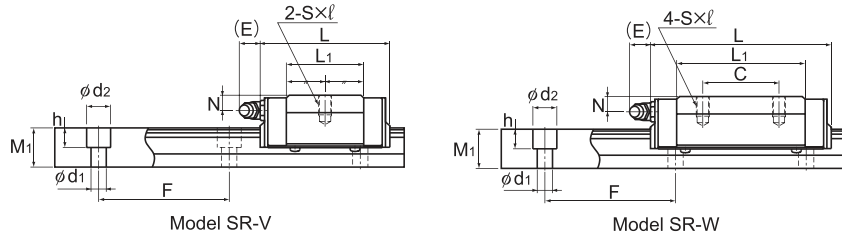

Unit: mm

|  | LM rail dimensions               |                |                          |            |                                     |                | Basic load rating |                      | Static permissible moment kN-m* |                |                  |                |                 |               | Mass           |                 |
|--|----------------------------------|----------------|--------------------------|------------|-------------------------------------|----------------|-------------------|----------------------|---------------------------------|----------------|------------------|----------------|-----------------|---------------|----------------|-----------------|
|  | Width<br>W <sub>1</sub><br>±0.05 | W <sub>2</sub> | Height<br>M <sub>1</sub> | Pitch<br>F | d <sub>1</sub> × d <sub>2</sub> × h | Length*<br>Max | C<br>kN           | C <sub>0</sub><br>kN | M <sub>A</sub>                  |                | M <sub>B</sub>   |                | M <sub>C</sub>  |               | LM block<br>kg | LM rail<br>kg/m |
|  |                                  |                |                          |            |                                     |                |                   |                      | 1 block                         | Double blocks  | 1 block          | Double blocks  | 1 block         | Double blocks |                |                 |
|  | 1 block                          |                | Double blocks            |            | 1 block                             |                | Double blocks     |                      | 1 block                         |                | Double blocks    |                |                 |               |                |                 |
|  | 15                               | 9.5            | 12.5                     | 60         | 3.5 × 6 × 4.5                       | 2500<br>(2500) | 9.51<br>5.39      | 19.3<br>11.1         | 0.0925<br>0.0326                | 0.516<br>0.224 | 0.0567<br>0.0203 | 0.321<br>0.143 | 0.113<br>0.0654 | 0.2<br>0.12   | 1.2            |                 |
|  | 20                               | 11             | 15.5                     | 60         | 6 × 9.5 × 8.5                       | 4000<br>(3000) | 12.5<br>7.16      | 25.2<br>14.4         | 0.146<br>0.053                  | 0.778<br>0.332 | 0.0896<br>0.0329 | 0.481<br>0.21  | 0.194<br>0.11   | 0.3<br>0.2    | 2.1            |                 |
|  | 23                               | 12.5           | 18                       | 60         | 7 × 11 × 9                          | 4000<br>(3000) | 20.3<br>11.7      | 39.5<br>22.5         | 0.286<br>0.103                  | 1.52<br>0.649  | 0.175<br>0.0642  | 0.942<br>0.41  | 0.355<br>0.201  | 0.4<br>0.3    | 2.7            |                 |
|  | 28                               | 16             | 23                       | 80         | 7 × 11 × 9                          | 4000<br>(3000) | 30<br>17.2        | 56.8<br>32.5         | 0.494<br>0.163                  | 2.55<br>1.08   | 0.303<br>0.102   | 1.57<br>0.692  | 0.611<br>0.352  | 0.8<br>0.5    | 4.3            |                 |
|  | 34                               | 18             | 27.5                     | 80         | 9 × 14 × 12                         | 4000<br>(3000) | 41.7<br>23.8      | 77.2<br>44.1         | 0.74<br>0.259                   | 4.01<br>1.68   | 0.454<br>0.161   | 2.49<br>1.07   | 1.01<br>0.576   | 1.2<br>0.8    | 6.4            |                 |
|  | 45                               | 20.5           | 35.5                     | 105        | 11 × 17.5 × 14                      | 3500           | 55.3              | 101                  | 1.1                             | 5.96           | 0.679            | 3.69           | 1.77            | 2.2           | 11.3           |                 |
|  | 48                               | 26             | 38                       | 120        | 14 × 20 × 17                        | 3000           | 89.1              | 157                  | 2.27                            | 11.3           | 1.39             | 6.98           | 2.87            | 3.6           | 12.8           |                 |
|  | 70                               | 28             | 47                       | 150        | 18 × 26 × 22                        | 3000           | 156               | 266                  | 2.54                            | 13.2           | 2.18             | 11.3           | 4.14            | 7             | 22.8           |                 |
|  | 85                               | 35.5           | 65.5                     | 180        | 18 × 26 × 22                        | 3000           | 120               | 224                  | 2.54                            | 15.1           | 1.25             | 7.47           | 5.74            | 10.1          | 34.9           |                 |
|  | 100                              | 39             | 70.3                     | 210        | 22 × 32 × 25                        | 3000           | 148               | 283                  | 3.95                            | 20.9           | 1.95             | 10.3           | 8.55            | 14.1          | 46.4           |                 |
|  | 114                              | 45.5           | 65                       | 230        | 26 × 39 × 30                        | 3000           | 279               | 377                  | 5.83                            | 32.9           | 2.87             | 16.2           | 13.7            | —             | —              |                 |
|  | 144                              | 53             | 77                       | 250        | 33 × 48 × 36                        | 3000           | 411               | 537                  | 9.98                            | 55.8           | 4.92             | 27.5           | 24.3            | —             | —              |                 |

Note1) Symbol M indicates that stainless steel is used in the LM block, LM rail and balls. Those models marked with this symbol are therefore highly resistant to corrosion and environment.  
Those model numbers including and greater than SR85T are semi-standard models. If desiring these models, contact THK.

Models SR85T and SR100T are equipped with grease nipple on the side face of the LM block.  
The maximum length under "Length\*" indicates the standard maximum length of an LM rail. (See B-90.)  
Static permissible moment\*: 1 block: static permissible moment value with 1 LM block

Double blocks: static permissible moment value with 2 blocks closely contacting with each other

Note2) The LM rail mounting hole of SR15 is drilled for M3 screws as standard (without Y indication). If you order the hole to be drilled for M4 screws (with Y indication), contact THK. When replacing this model with model SSR, pay attention to the dimension of the rail mounting hole.